



30 Capital Drive Grovedale VIC

A rare find in one of Geelong's most popular industrial estates. This recently refurbished warehouse with offices is located just off the busy Surfcoast Highway and provides easy access to the Geelong CBD, Torquay, Geelong Ring Road, western districts & the Bellarine Peninsula. Substantial off-street carparking and/or storage yard provides substantial value. Nearby businesses include ALDI, IGA, APCO, Total Tools, Carpet Court, National Tiles, KFC, Blackmans Brewery and many more.

- * Building floor area of approx. 400m²
- * Warehouse with 3 x roller doors and 3 phase power
- * Two level office area includes reception, storage, offices, kitchenettes (x2) and amenities (including shower)
- * Over 850m² of concrete and hardstand yard behind a

Type	: Industrial
Price	: \$85,000pa + GST & O/Gs
Building Size	: 400 sqm
View	: https://www.maxwellcollins.com.au/lease/vic/geelong-district/grovedale/commercial/industrial/8462369



Paul Whyte
03 5222 4711

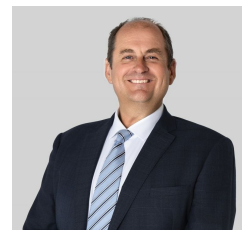

Mathew George
03 5222 4711

[For full version visit the website](https://www.maxwellcollins.com.au)

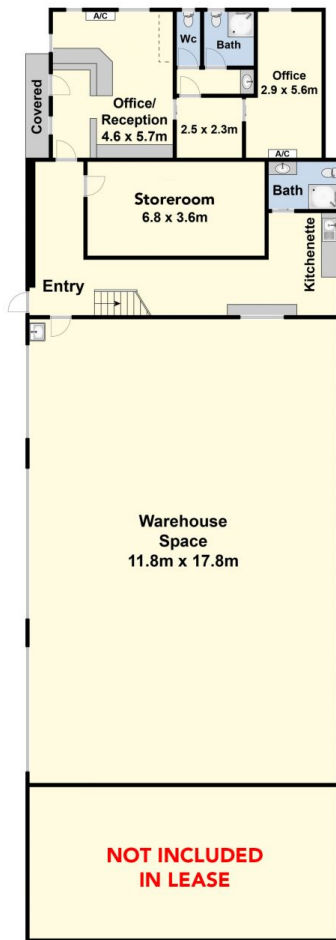

Ground Floor

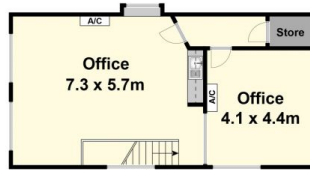

First Floor

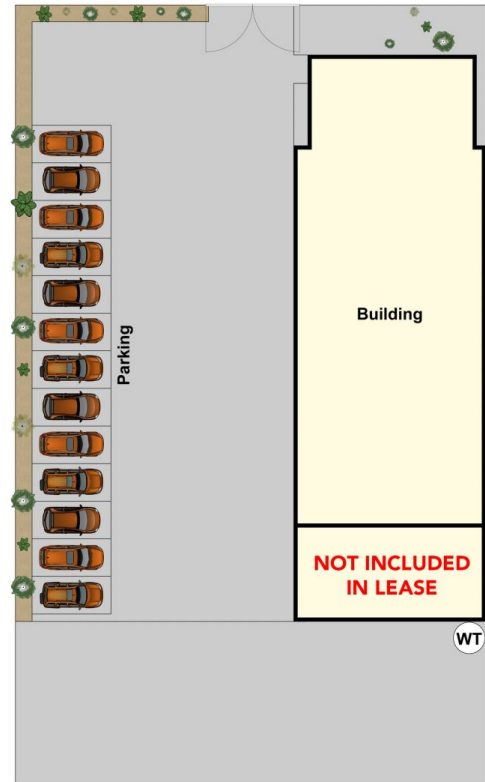

Site Plan

Approx Land Area: 1491m²