

14 Plantation Road Corio VIC

- * Main road location with good accessibility
- * Ideally positioned in the heart of Geelong's Northern Suburbs & only 15min* to CBD
- * Adjoining busy child care centre (Happy Feet Early Learning Centre)
- * Building area 155sqm*
- * High quality building with reception & waiting areas
- * Up to 4 suites/offices plus storage
- * 7 car parks designated
- * Competitive rental on offer
- (* denotes approx.)

Type	: Offices
Price	: \$35,000pa plus GST & O/Gs
Building Size	: 155 sqm
View	: https://www.maxwellcollins.com.au/lease/vic/geelong-district/corio/commercial/offices/8296371

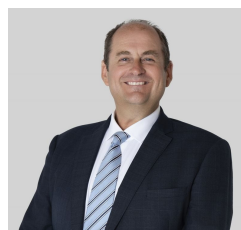

Mathew George
03 5222 4711



Paul Whyte
03 5222 4711

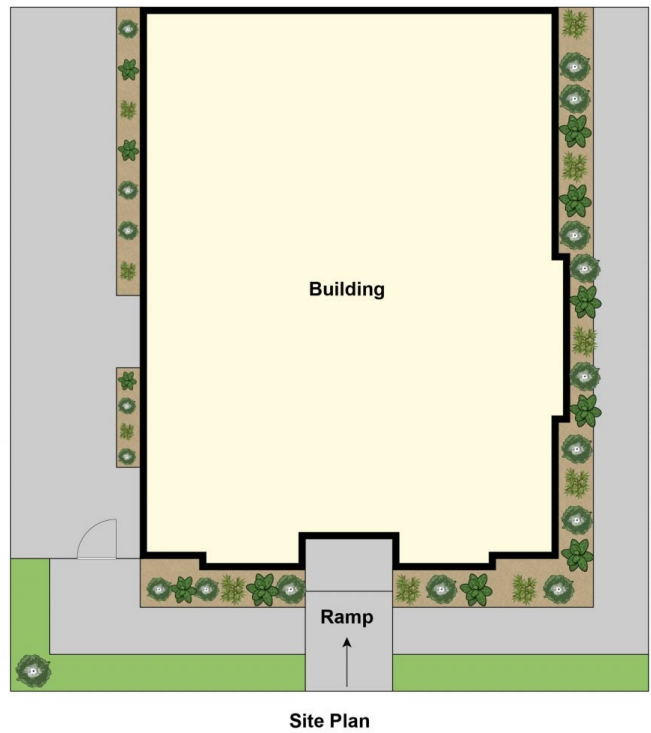
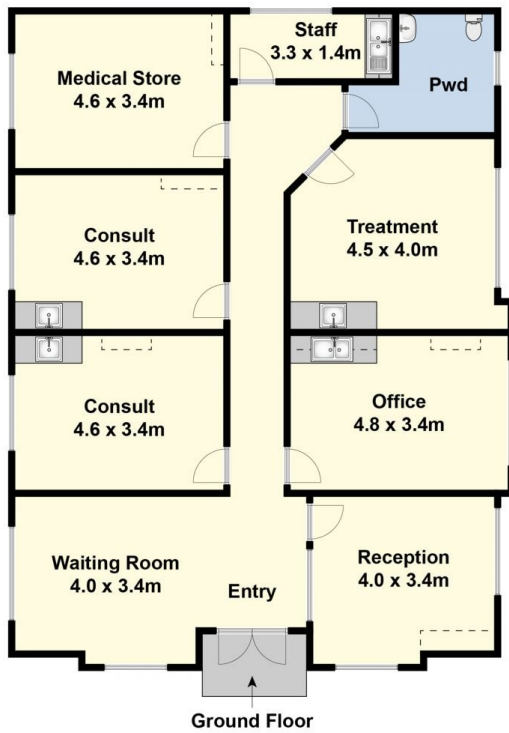

Approx building size: 155m²