



6 Raptor Place South Geelong VIC

2 

- * Approx. 224m2 ground floor and mezzanine (approx. 42m2)
- * High span with high roller door
- * Office, kitchenette, amenities, 3 phase power, heating and cooling
- * Located in popular industrial estate
- * Suits owner occupier or investor
- * Industrial 1 zone

Type : Industrial
Price : \$850,000 - \$890,000 + GST
Building Size : 266 sqm
View : <https://www.maxwellcollins.com.au/sale/vic/geelong-district/south-geelong/commercial/industrial/8248042>



Paul Whyte
03 5222 4711



Ground Floor

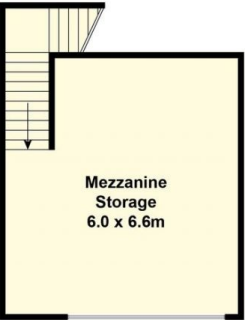

Upper Floor



Site Plan