

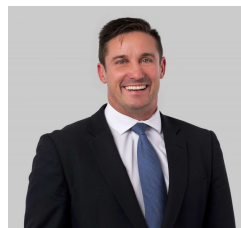

155 Weddell Road North Geelong VIC

- * Beautifully fitted out two level offices
- * Three side roller doors
- * Lunch room (with alfresco deck), showroom, amenities, boardroom
- * Fully fenced with lockable gates
- * Off street parking, solar power, 3 phase power
- * Zoned Industrial 1

Type : Industrial
Price : \$195,000pa + GST & O/Gs
Building Size : 1485 sqm
View : <https://www.maxwellcollins.com.au/lease/vic/geelong-district/north-geelong/commercial/industrial/8188097>



Paul Whyte
03 5222 4711

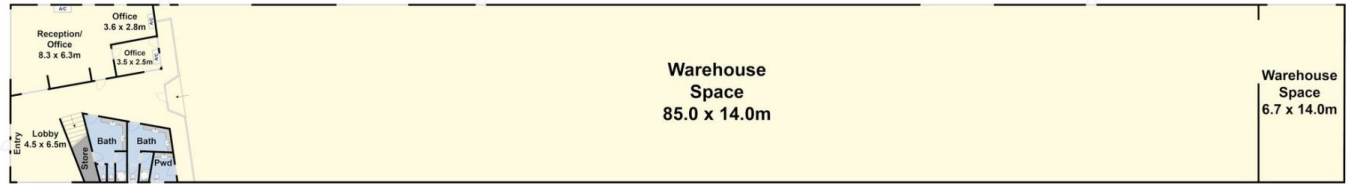
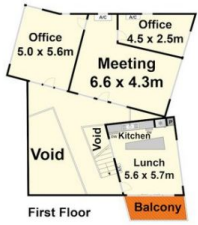

Ground Floor

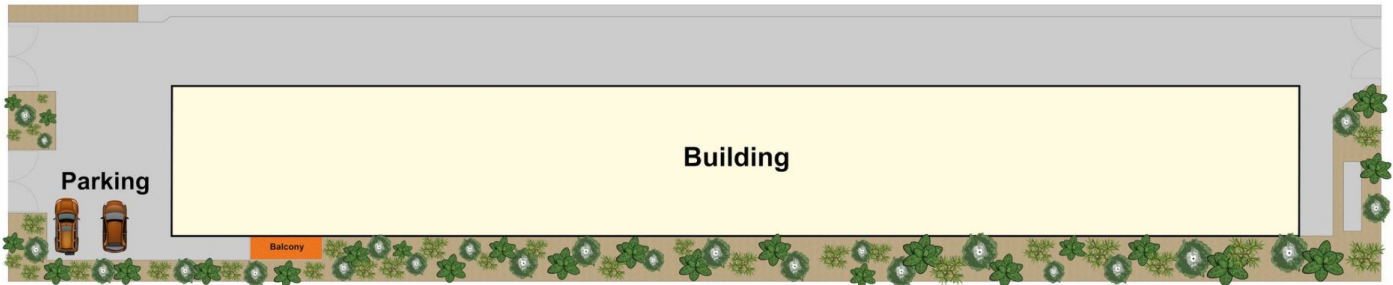

Site Plan