

22A Tarkin Court Bell Park VIC

- * Approx 400m2 floor area (including 50m2 mezzanine)
- * High span with reception, office, kitchenette and amenities
- * 3 phase power, LED lights and off street parking
- * Industrial 1 zone

Type : Industrial
Price : \$52,000pa + GST & O/Gs
Building Size : 400 sqm
View : <https://www.maxwellcollins.com.au/lease/vic/geelong-district/bell-park/commercial/industrial/8153478>

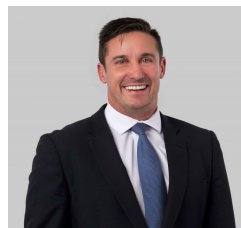

Paul Whyte
03 5222 4711

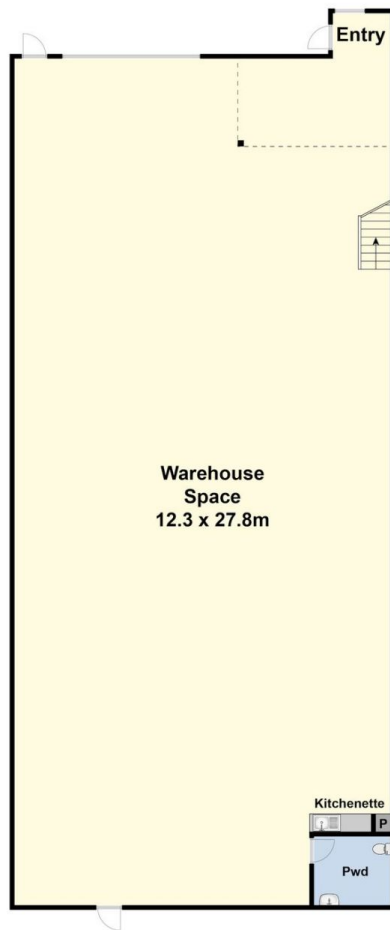

Ground Floor



First Floor

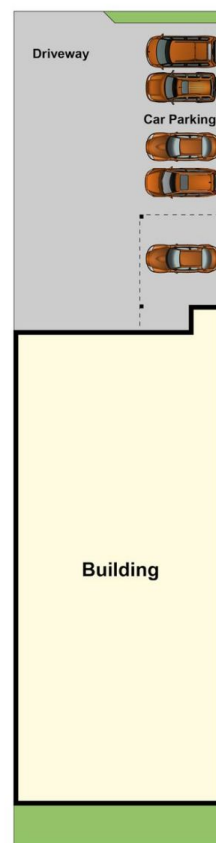

Site Plan