



11/259 Bellerine Street South Geelong VIC

3 **2** **1**

A modern townhouse which offers a blend of style and convenience, ideal for those seeking an urban lifestyle with quick access to the coast. With its light-filled interiors and a generous 346m2 allotment, the property is situated near the upgraded South Geelong Station and Foster Street Reserve, offering easy access to to the CBD, GMHBA Stadium, waterfront, hospitals, and local amenities.

The home features three spacious bedrooms, the master includes walk-in robe and ensuite, remaining bedrooms each have built-in robes and share a deluxe family bathroom. The open-plan living and dining areas with high ceilings provide a spacious feel, flowing into a well-manicured backyard, boasting paved and deck areas, perfect for entertaining.

[For full version visit the website](https://www.maxwellcollins.com.au)

Type : Townhouse
Price : \$859,000 - \$900,000
Land Size : 346 sqm
View : <https://www.maxwellcollins.com.au/sale/vic/geelong-district/south-geelong/residential/townhouse/8141832>



Laura Vander Noord
03 5222 4711



Duncan Skene
03 5222 4711

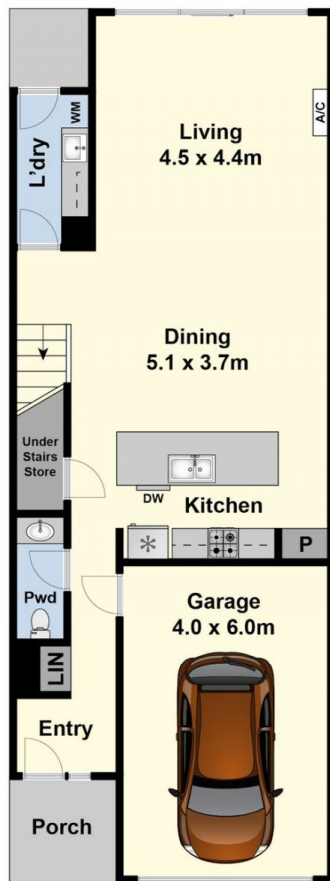

Ground Floor

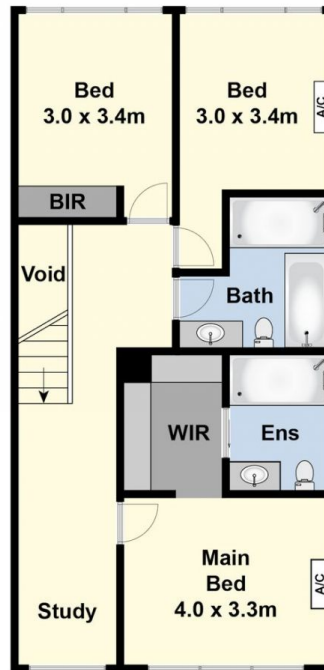

First Floor

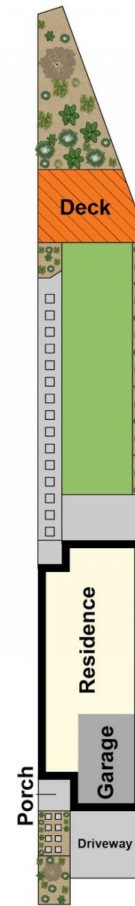

Site Plan