



5/4 Reeves Court Breakwater VIC

- * Located in popular industrial estate
- * Approx. 954m² floor area
- * High span ceiling
- * Rear roller door with semi vehicle access
- * Side concreted driveway access
- * 3 phase power
- * Off street car parking available
- * Share of hardstand negotiable*

Price : \$110,000pa* + GST & O/Gs
Building Size : 954 sqm
View : <https://www.maxwellcollins.com.au/lease/vic/geelong-district/breakwater/commercial/industrial/7967621>



Paul Whyte
03 5222 4711

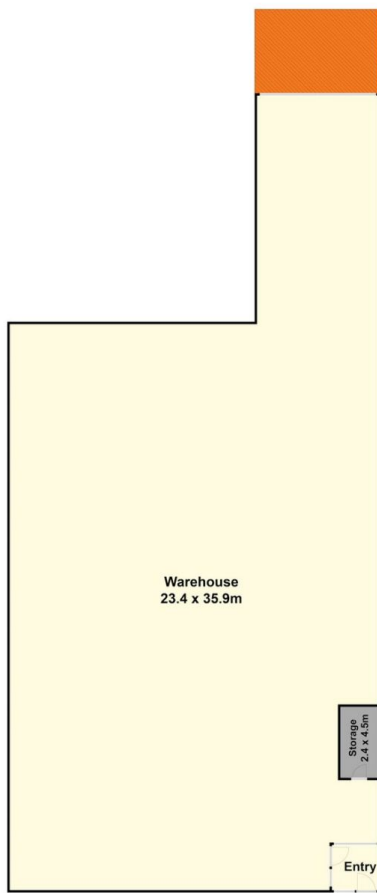

Ground Floor

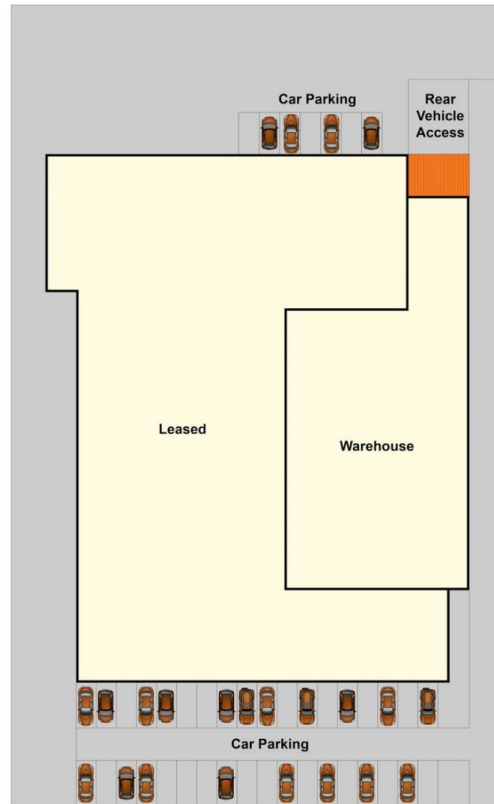

Site Plan