

180 Latrobe Terrace Geelong West VIC

- * Glass front showroom and warehouse with rear access and loading dock
- * Off street carparks
- * Periodic lease in place
- * Opposite Geelong Railway Station
- * Commercial 2 zone

Type	: Showrooms/Bulky Goods
Price	: \$1,100,000 - \$1,200,000
Building Size	: 360 sqm
Land Size	: 542 sqm
View	: https://www.maxwellcollins.com.au/sale/vic/geelong-district/geelong-west/commercial/showroomsbulky-goods/7966010



Paul Whyte
03 5222 4711

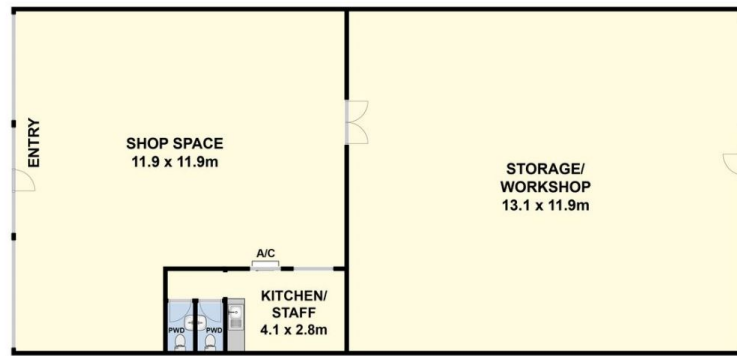

GROUND FLOOR

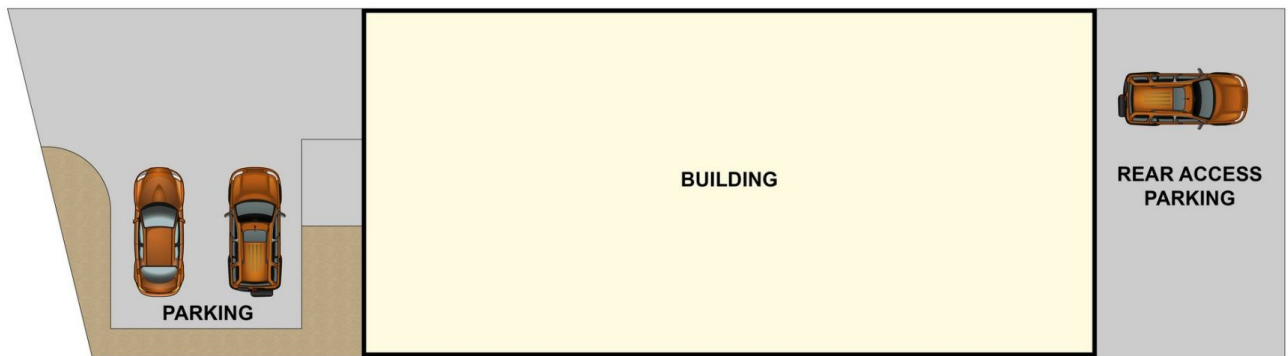

SITE PLAN