



2/8 Dorothy Street Leopold VIC

- * Central open space area with 3 separate offices
- * Kitchenette and amenities
- * Full glass front
- * Approx. 70m²
- * Commercial 1 zone

Price : \$19200pa plus GST & OGS
Building Size : 70 sqm
View : <https://www.maxwellcollins.com.au/lease/vic/geelong-district/leopold/commercial/offices/7934095>



Paul Whyte
03 5222 4711



James Woof
03 5222 4711

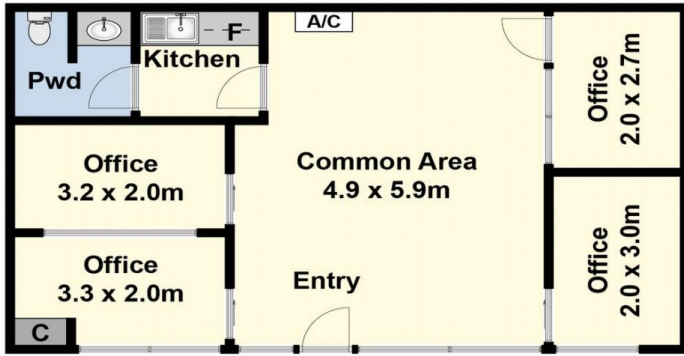

Ground Floor

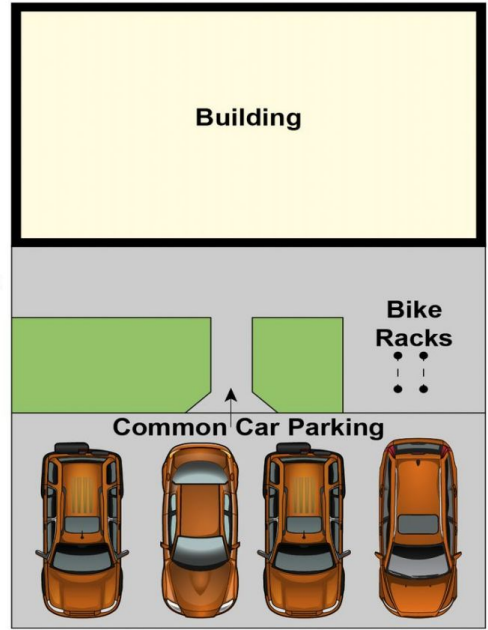

Site Plan