



DISCLAIMER: This drawing is indicative only & all measurements are approximate.



## 412 Thompson Road North Geelong VIC

- \* Two separate buildings on site
- \* Office, reception and workshop space
- \* Spray booth and amenities
- \* 3 phase power, air compressor and gas lines
- \* Alarm system, solar panels and roller door
- \* Water treatment plant
- \* Zoned Industrial 1

**Type** : Industrial  
**Price** : \$990,000 - \$1,080,000  
**Building Size** : 380 sqm  
**Land Size** : 928 sqm  
**View** : <https://www.maxwellcollins.com.au/sale/vic/geelong-district/north-geelong/commercial/industrial/7882568>



**Paul Whyte**  
03 5222 4711

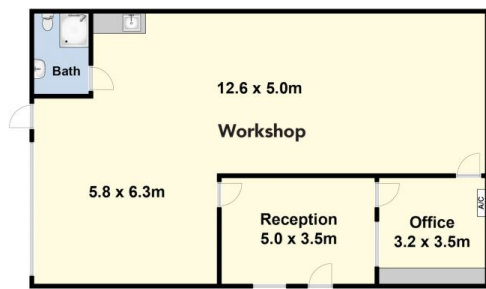

Warehouse

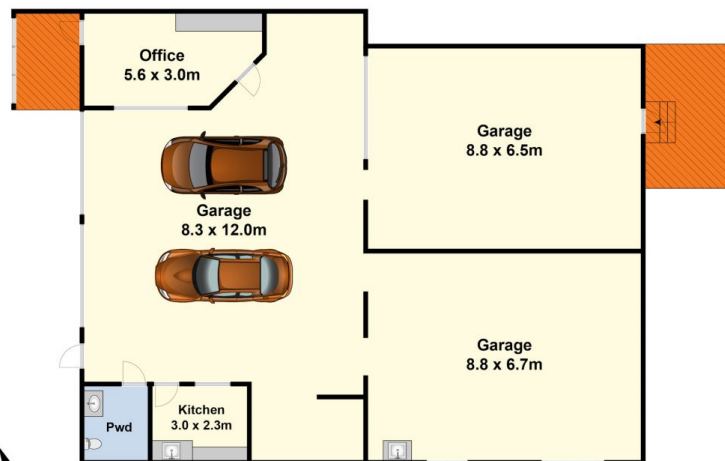

(Not In Position)

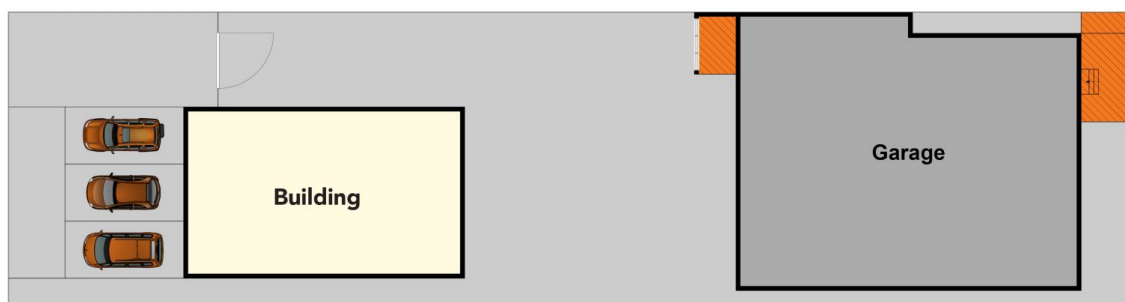

Site Plan