



2/15 Natika Court Grovedale VIC

2 1 1

This two-bedroom unit presents a fantastic opportunity for anyone looking to downsize, a first home buyer looking to enter the market, or anyone in search of low maintenance living. The home has been well looked after and boasts a fantastic size yard for a unit.

Featuring a central lounge with gas wall heater, a functional size kitchen with gas cooktop, oven and adjacent meals area, two bedrooms with built-in robes, a bathroom with shower, bath and separate toilet, a rear sunroom and a single garage with automatic door. Split system air-conditioning and ceiling fans provide comfortable living all year-round. Outside features a private yard and boasts plenty of space for pets and even a veggie garden.

Type : Unit
View : <https://www.maxwellcollins.com.au/sale/vic/geelong-district/grovedale/residential/unit/7840392>



Shaun Carroll
03 5222 4711



Lois Wilson
03 5222 4711

[For full version visit the website](https://www.maxwellcollins.com.au)



Ground Floor

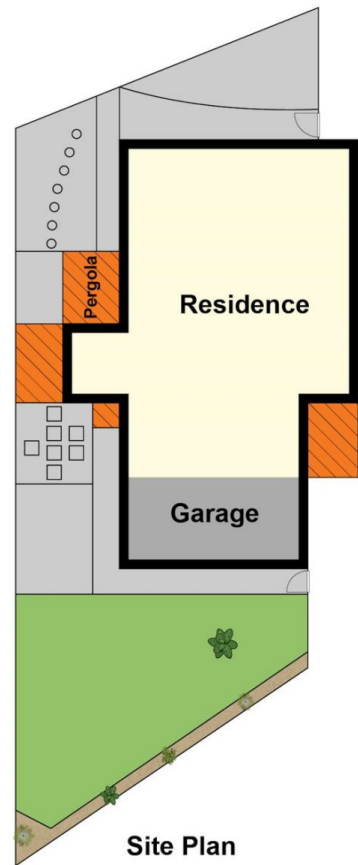

Site Plan