

**Suite 3, 1/47 Pakington Street Geelong West VIC**

**4** 

- \* Lift and stair access to approx. 370m2.
- \* 4 allocated car parks, heating/cooling, kitchen and amenities
- \* Foyer and meeting rooms upon entry
- \* Close to everything Pakington Street has to offer
- \* Zoning - Commercial 2

**Type** : Offices  
**Building Size** : 370 sqm  
**View** : <https://www.maxwellcollins.com.au/lease/vic/geelong-district/geelong-west/commercial/offices/7549000>

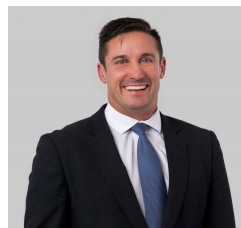

**Paul Whyte**  
**03 5222 4711**



Ground Floor

First Floor

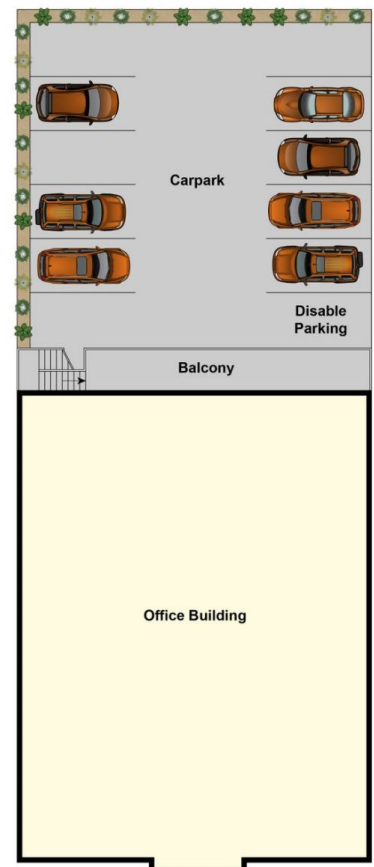

Site Plan