



## 272 Latrobe Terrace Newtown VIC

Set on 1885m2 of prime Newtown land. Two main buildings "Roslyn" circa 1850's and the adjoining art deco style building circa 1920's. Currently divided into 9 units with a gross income of \$126,000 pa. 7x1 bedroom, 1x2 bedroom and 1x4 bedroom. Located on the corner of Roebuck Street, with off street parking available, the property has bay views along with convenient access to the city, train station and Kardinia Park. The prominent position has high exposure and is ideally suited for apartment development, renovation or consulting rooms. (STCA). Zoned GRZ4.

**Price** : \$3,000,000 - \$3,300,000  
**Building Size** : 960 sqm  
**Land Size** : 1885 sqm  
**View** : <https://www.maxwellcollins.com.au/sale/vic/geelong-district/newtown/commercial/development/7471613>



**Duncan Skene**  
03 5222 4711



**Eugene Carroll**  
03 5222 4711

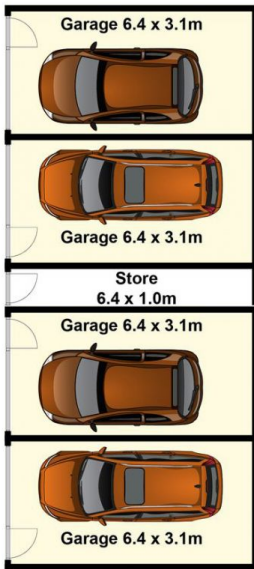

(Not In Position)



(Not In Position)

**SITE PLAN & OUTBUILDINGS**

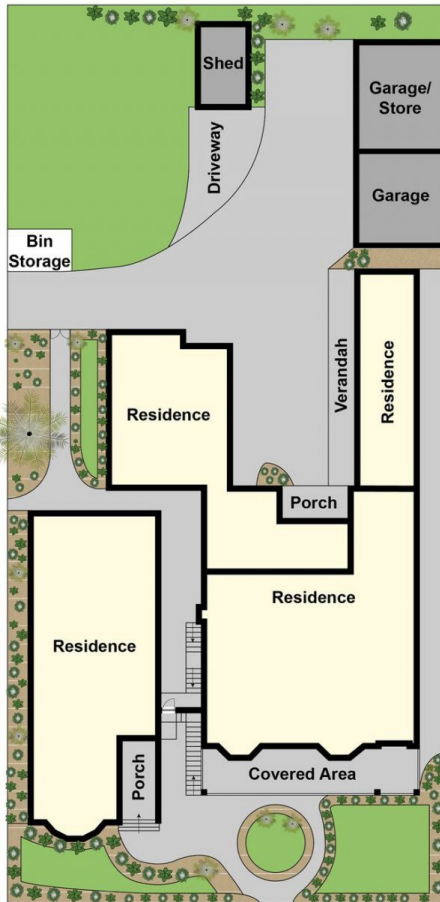

Site Plan