



7 Melva Crescent Whittington VIC

3 1 2

Wonderfully presented throughout, this quality home is situated on a massive allotment of 734m² (approx.) offers convenient living in a family friendly and peaceful location all while boasting a welcoming street appeal with immaculate gardens and plenty of space for parking. Inside the home, the light-filled main living area offers a spacious area to relax or entertain and enjoys the comfort of a wood fire. The adjoining kitchen and meals area also provides ample space and provides modern convenience with a 900mm oven and Dishwasher. Comprising three good size bedrooms in total, two with built-in robes and all serviced by a central bathroom. To the rear of the home is the second living area which provides all the extra living space one could need and opens onto the expansive & private backyard which offers plenty of play space for the kids or

Type : House
Price : \$ 500,000
Land Size : 734 sqm
View : <https://www.maxwellcollins.com.au/sale/vic/geelong-district/whittington/residential/house/7457411>



Simon Braybrook
 03 5222 4711

[For full version visit the website](https://www.maxwellcollins.com.au)

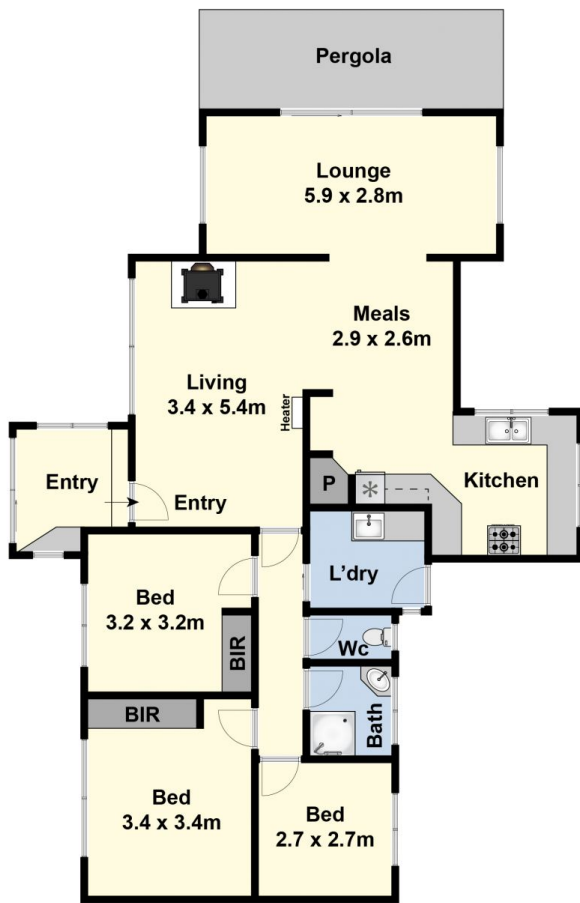

Ground Floor



(Not In Position)

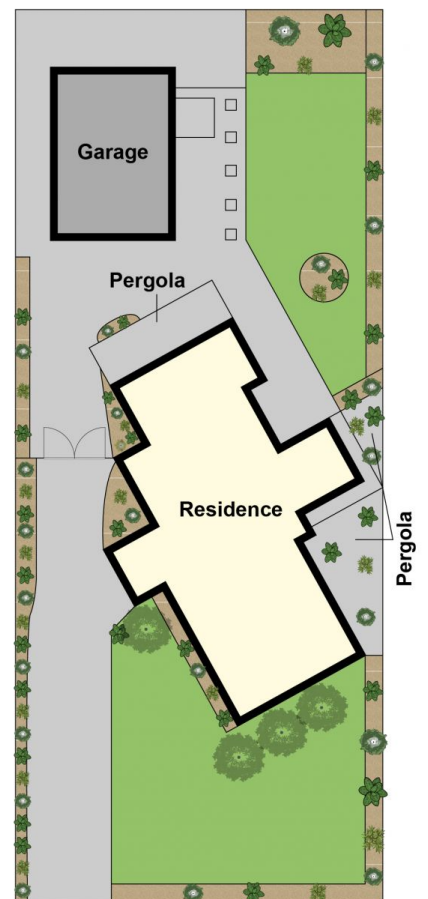

Site Plan