



25 Phalaris Park Drive Lovely Banks VIC

4 2 2

Ideally situated in the ever-popular Phalaris Park estate, this family-size abode presents the perfect opportunity to secure quality real estate while putting your own stamp on it. Boasting 625m² (approx.) of land & four bedrooms in total, Master with ample room for a parents retreat as well as walk-in robe & Ensuite. The three remaining bedrooms also provide built-in robes. The open plan living, kitchen and dining space serves as the hub of the home. A second living space allows the family to branch out and enjoy some extra space. The kitchen features stainless steel appliances and contemporary fixtures while being all tastefully designed. Heading outside you'll fall in love with the undercover alfresco area which is perfect for entertaining and overlooks the substantially sized backyard offering endless possibilities.

[For full version visit the website](https://www.maxwellcollins.com.au)

Type : House
Price : \$ 760,000
Land Size : 625 sqm
View : <https://www.maxwellcollins.com.au/sale/vic/geelong-district/lovely-banks/residential/house/7457403>



Simon Braybrook
03 5222 4711



Lois Wilson
03 5222 4711

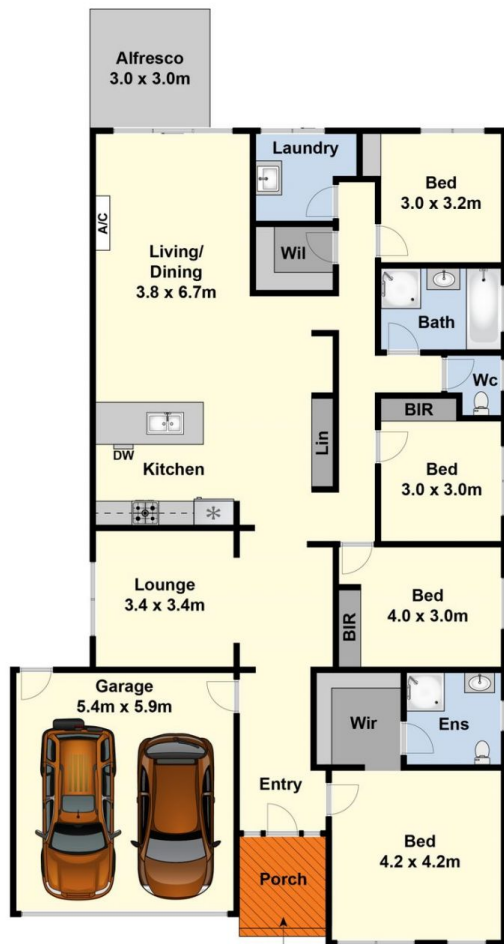

Ground Floor

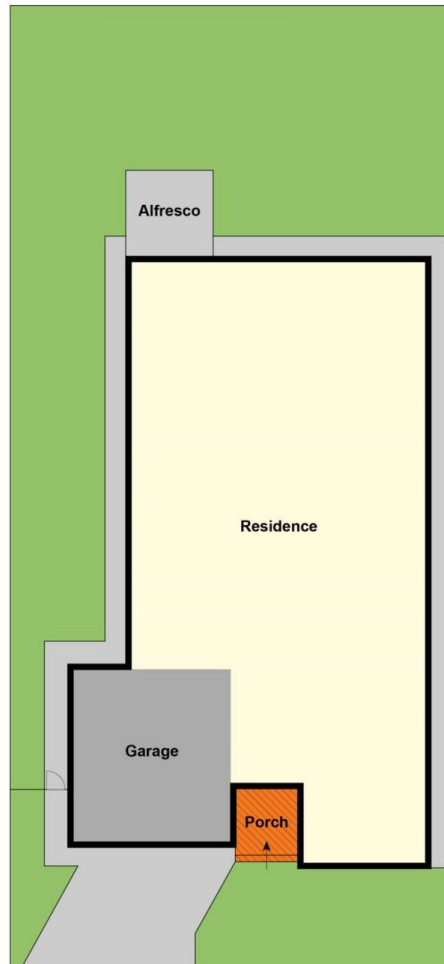

Site Plan