



115 Curtain Drive Leopold VIC

3 2 2

Situated in a family friendly location & surrounded by established homes, this gorgeous abode has appeal that is sure to impress all buyer types looking in the Leopold area. Comprising of 3 Bedrooms in total, Master with ensuite and well-equipped WIR while the remaining two bedrooms also provide BIR's. A central open-plan living zone provides all the space one needs and boasts plenty of natural light and view to the large backyard. The central kitchen comes equipped with stainless appliances including 900mm oven, a large island bench and good sized pantry. There's also a large family bathroom, separate laundry, large linen/storage cupboard in the main hallway and a large lock up garage with internal access.

Outside the home you'll be met with a substantially sized

[For full version visit the website](https://www.maxwellcollins.com.au)

Type : House
Price : \$ 700,000
Land Size : 534 sqm
View : <https://www.maxwellcollins.com.au/sale/vic/geelong-district/leopold/residential/house/7457401>



Simon Braybrook
 03 5222 4711

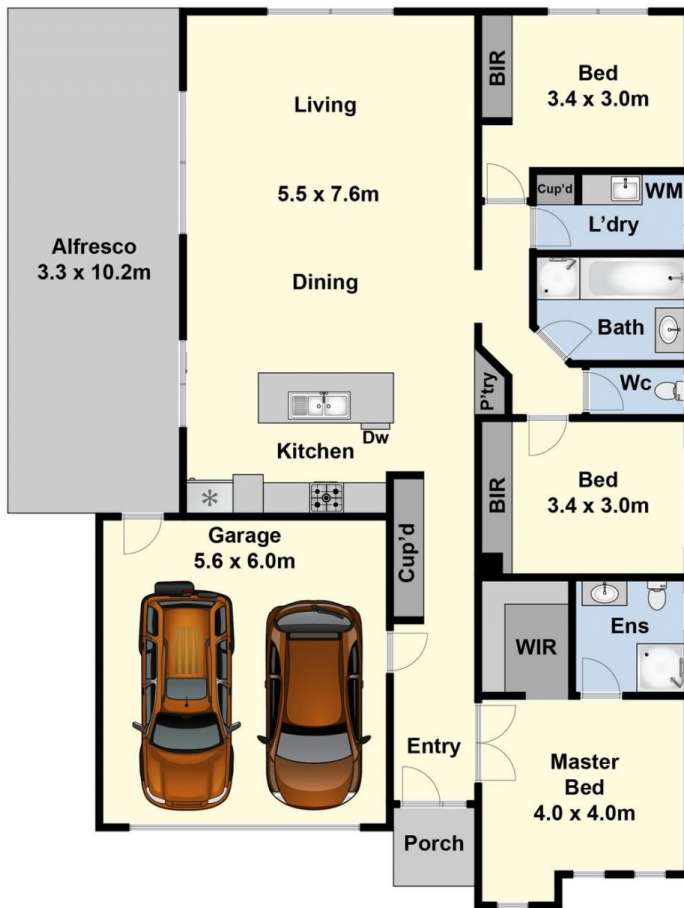

Ground Floor

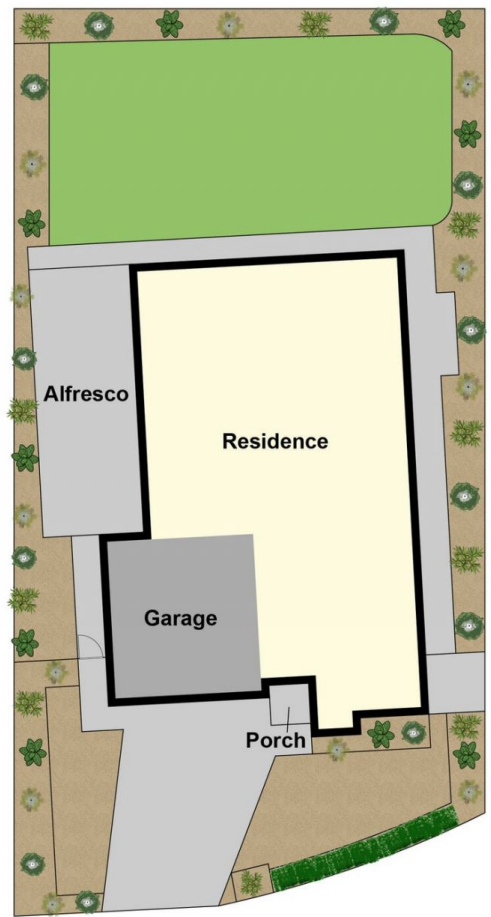

Site Plan