



128 Sovereign Drive Mount Duneed VIC

3 2 1

This brick veneer home is situated in the sought-after area of Mount Duneed and presents a fantastic opportunity for first home buyers, investors and downsizers looking for an affordable, low maintenance home. Boasting comfortable living, the home features a light filled open plan living space, a fully equipped kitchen with gas cooking and dishwasher, a main bedroom with walk-in robe and ensuite, while a further two bedrooms include built-in robes, a family bathroom, cleverly concealed European laundry, a large single garage with internal access and ample storage. Extra comforts include gas central heating, split-system air-conditioning and ceiling fans in the bedrooms. Outside features a private and neatly landscaped rear yard. Walking distance to Club Armstrong, sporting ovals, Mirripoa primary school, the local cafe and the future Mount

Type : House
Price : \$ 605,000
Land Size : 220 sqm
View : <https://www.maxwellcollins.com.au/sale/vic/geelong-district/mount-duneed/residential/house/7457363>



Shaun Carroll
03 5222 4711



Eugene Carroll
03 5222 4711

[For full version visit the website](https://www.maxwellcollins.com.au)

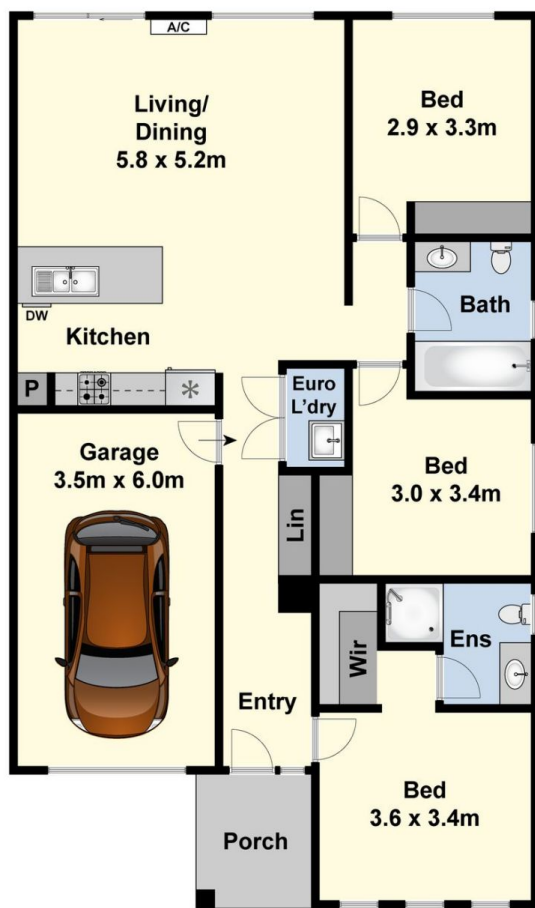

Ground Floor

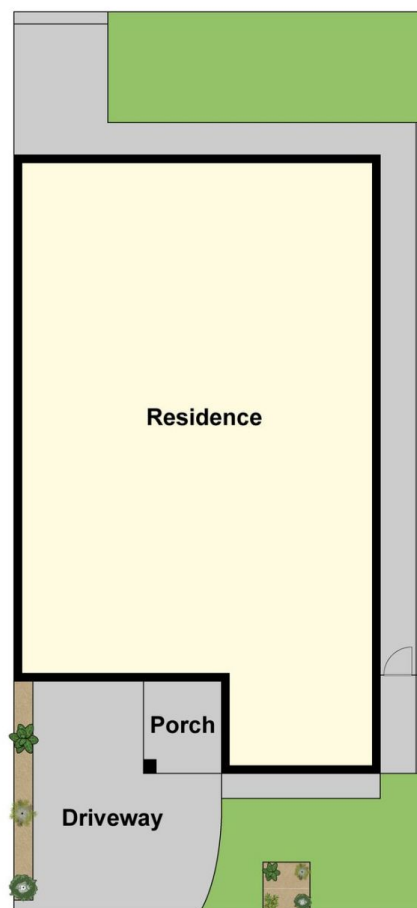

Site plan