



## 48 Stevenson Road Bannockburn VIC

5 2 2

This divine family home rests on a peaceful 3 acres with an abundance of space for the whole family. Showcasing a flexible floorplan, relax with guests in the elegant lounge room warmed by a log fire; leading to a vast open plan dining area featuring a kitchen that is as practical as it is beautiful, appointed with a huge island breakfast bar smothered in stone, premium appliances throughout and a large butler's pantry.

Large floor-to-ceiling windows and doors provide a seamless connection to the outdoor entertaining area; comprising a beautifully landscaped lawn, a covered alfresco deck leading to a tranquil north-facing backyard with a heated pool.

**Type** : Acreage/Semi-Rural  
**Land Size** : 3 Acres  
**View** : <https://www.maxwellcollins.com.au/sale/vic/geelong-district/bannockburn/residential/acreagesemirural/7457125>



**Duncan Skene**  
03 5222 4711



**Laura Vander Noord**  
03 5222 4711

[For full version visit the website](https://www.maxwellcollins.com.au)



Ground Floor

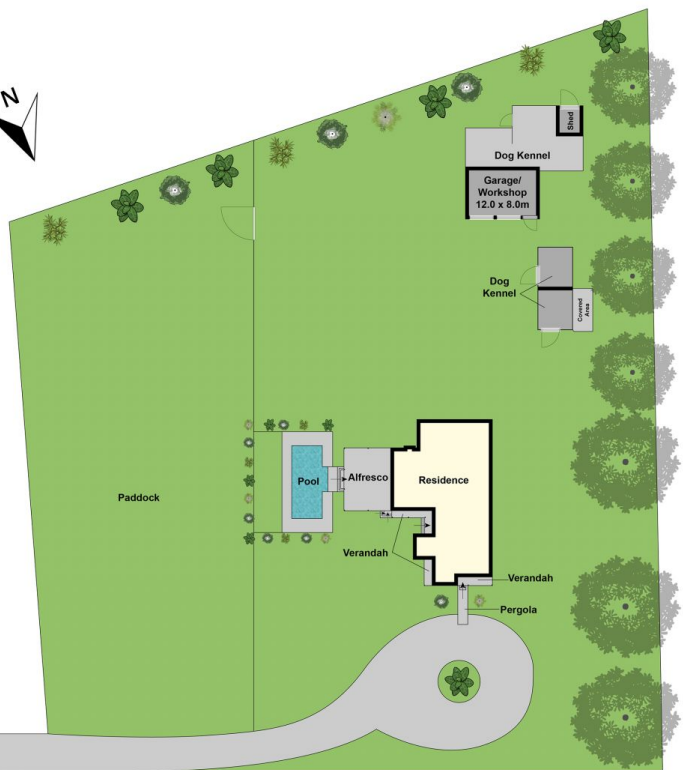

Site Plan