



23 Morrow Crescent Leopold VIC

4 2 2

Located in a family friendly neighbourhood and close to schools and shops is this appealing 4 bedroom heritage style home. The tiled entrance leads to a spacious open plan living with a fully equipped modern kitchen with large island bench and tiled meals area with access onto a timber deck with northerly aspect. Other features include formal lounge, main bedroom with walk in robe and ensuite, central heating, evaporative cooling, split airconditioner, main bathroom with separate shower and bath, solar panels, double garage with auto door plus internal and through access to a low maintenance garden. The whole family will be happy with this one.

Type : House
Price : \$ 600,000
Land Size : 540 sqm
View : <https://www.maxwellcollins.com.au/sale/vic/geelong-district/leopold/residential/house/7456982>



Eugene Carroll
03 5222 4711



Shaun Carroll
03 5222 4711

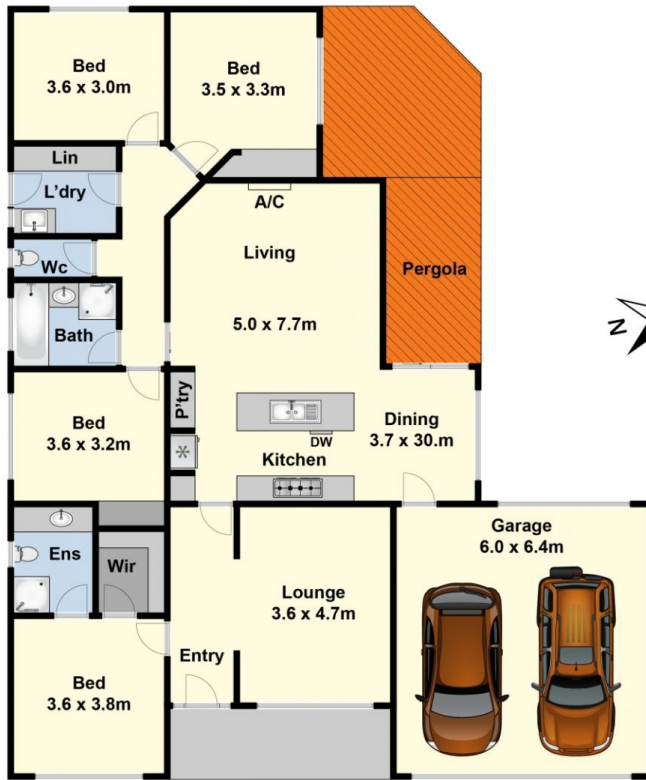

Ground Floor

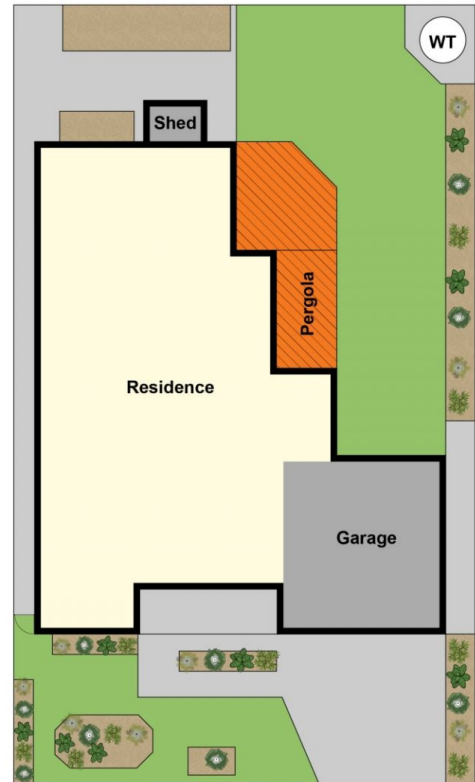

Site Plan