





9/31 Meadowvale Drive Grovedale VIC

3  **2**  **1** 

Built at the rear of the complex and just one year old is this uniquely designed three bedroom townhouse complete with WIR and ensuite. The atmosphere is light and airy in the open plan living area which has R/C air conditioning and central heating to provide for year-round comfort. The kitchen is well appointed with dishwasher and stone benchtops as well as stainless steel appliances. With the advantage of a generous private courtyard and internal access from the remote controlled garage this is indeed a most desirable layout. Currently tenanted this home represents an easy care investment for the astute investor, first home buyer or for someone considering downsizing in the near future. Boasting many appealing features this is one to put to the top of your list.

Type : Unit

View : <https://www.maxwellcollins.com.au/sale/vic/geelong-district/grovedale/residential/unit/7456975>



Lois Wilson
03 5222 4711



Nick Lord
03 5222 4711

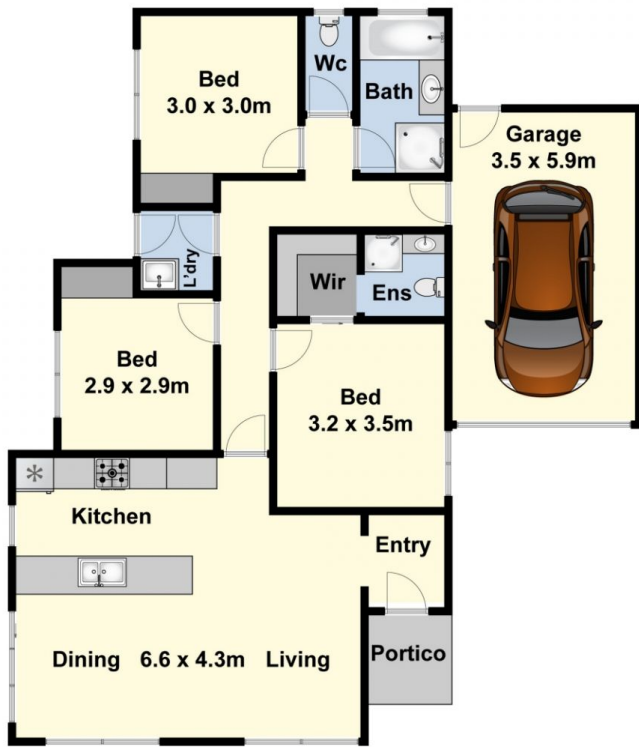

Ground Floor

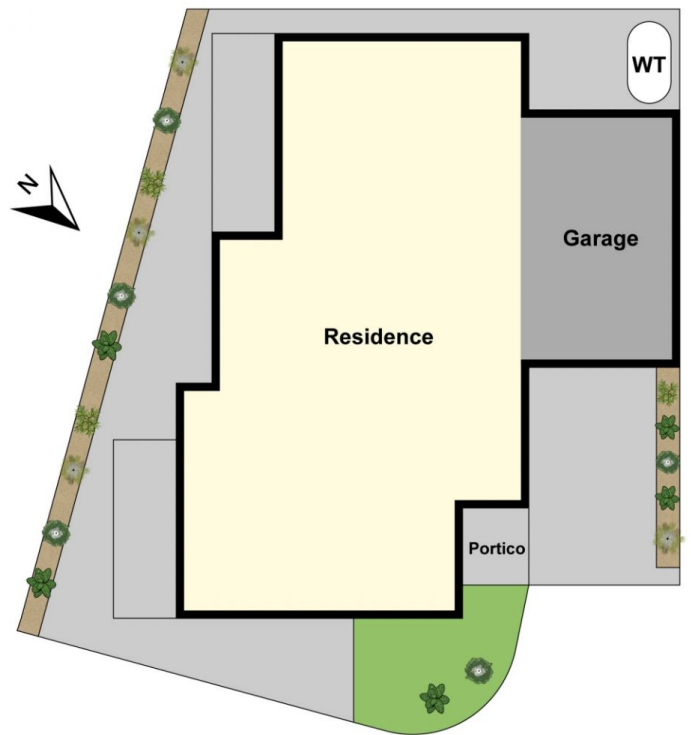

Site Plan