



216 Barwarre Road Grovedale VIC

3 1 2

Completely secure in manicured gardens, this sun drenched 3 bedroom single level home creates a low maintenance lifestyle. New carpet throughout, this stylish abode enjoys a wide entry hall, 3 bedrooms (BIRs, main with WIR and 2 way bathroom), separate laundry, a generously proportioned kitchen with stainless steel appliances. North/west facing open plan living with adjoining dining area and a covered entertaining area overlooking the sunny secure rear gardens. The home stays warm in winter and cool in summer with its ducted heating and split system air conditioner in the main living area, there are also ceiling fans throughout the home. Complete with double auto garage with a rear roller door and internal access. Enjoy the convenient location, close to the Grovedale Primary School, Marshall train station, local

Type : House

View : <https://www.maxwellcollins.com.au/sale/vic/geelong-district/grovedale/residential/house/7456839>



Laura Vander Noord
03 5222 4711



Duncan Skene
03 5222 4711

[For full version visit the website](https://www.maxwellcollins.com.au)



Ground Floor

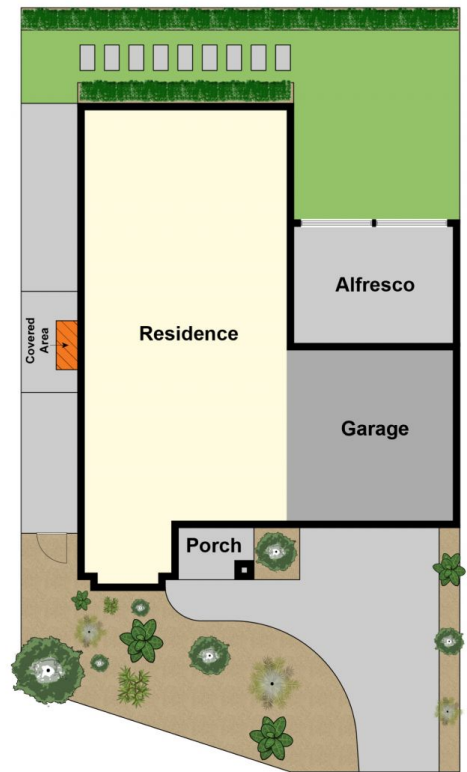

Site Plan