



## 21 St Cuthberts Court Marshall VIC

3 2 2

Ideally located at the top of a court and within walking distance of the Marshall Train Station this is a must for those commuting for work. Well presented throughout, the home has three bedrooms, study and ensuite, and has a great modern industrial feel with polished concrete floors and a huge undercover area complete with garden seating and fire pit. The alfresco area also has an impressive Glow in the Dark finish to the exposed aggregate concrete giving it a very special evening look. The stylish kitchen overlooks the open plan family area which features an electric log fire in addition to the cooling and central heating, whilst a separate theatre room with projector provides another great space for entertaining. Set on a generous allotment of approx 665sqm with double garage and room for extra vehicles there's ample room for the whole family to enjoy.

**Type** : House

**View** : <https://www.maxwellcollins.com.au/sale/vic/geelong-district/marshall/residential/house/7456706>



**Lois Wilson**  
03 5222 4711



**Duncan Skene**  
03 5222 4711

[For full version visit the website](https://www.maxwellcollins.com.au)



Ground Floor

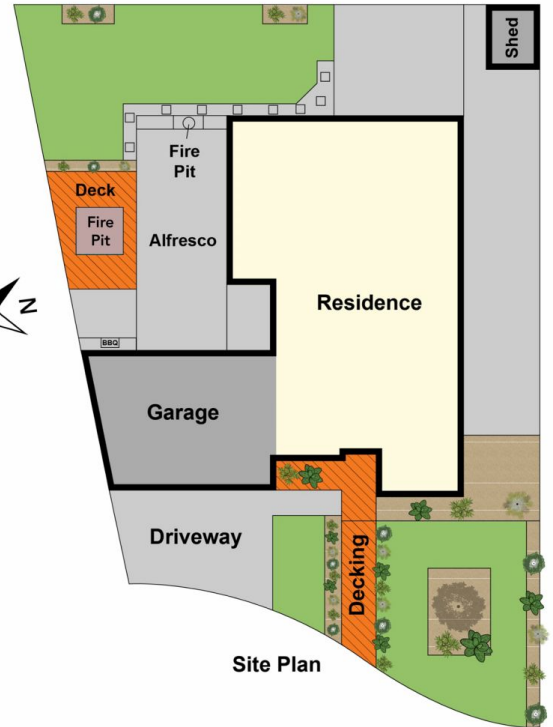

Site Plan