



15 & 15A Tate Street Thomson VIC

2 2 2

Here's an exciting opportunity for you to acquire 2 homes on the one title offering a range of options for the astute investor or developer. Set on approx 660sqm this unusual property comprises two dwellings - one as a single bedroom WB house and the other as a single bedroom BV style unit, both with separate driveways. Currently returning approx \$20,800 pa (gross) this property is ideal to add to your investment portfolio with further potential for re-development or subdivision (STCA), whilst providing a solid return whilst you finalise your plans. Consider your options. Terms: 10% Deposit, balance in 60 days. Photo ID required.

Type : House

View : <https://www.maxwellcollins.com.au/sale/vic/geelong-district/thomson/residential/house/7456523>



Lois Wilson
03 5222 4711

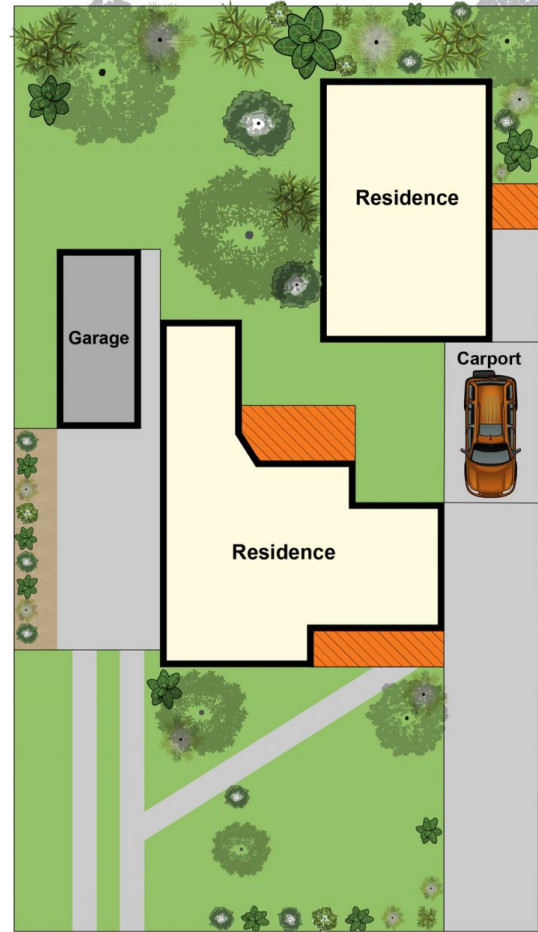
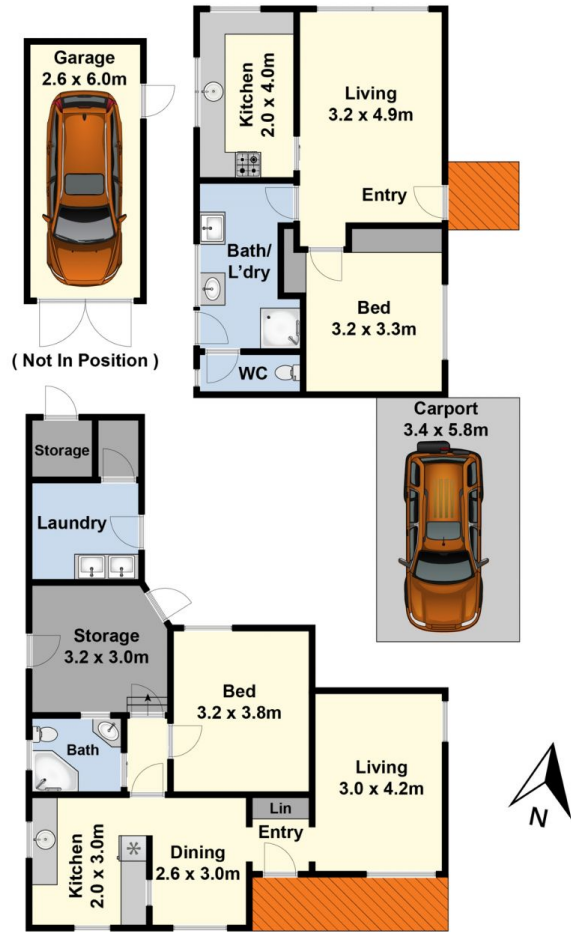

Site Plan