



4 Hyndford Court GROVEDALE VIC

4 2 2

This quality built brick veneer home boasts functionality and is sure to impress. Its abundance of space makes it ideal for a growing family. Featuring four good size bedrooms, the main includes a walk-in robe with custom shelving, and hanging area backing onto pantry and ensuite with double vanity and large shower, a front lounge which acts as a parents retreat, large windows and a skylight allows plenty of natural light into the sizable open plan living area, the fully equipped modern kitchen includes an electric cook-top, dishwasher and plenty of extra cupboard space, family bathroom with large shower and separate bath, the tiled meals space opens to a fantastic decked outdoor area which is ideal for entertaining, outside feels private and features a neatly landscaped garden, double lock up garage with internal access and through

Type : House

View : <https://www.maxwellcollins.com.au/sale/vic/geelong-district/grovedale/residential/house/7456340>



Shaun Carroll
03 5222 4711



Eugene Carroll
03 5222 4711

[For full version visit the website](https://www.maxwellcollins.com.au)

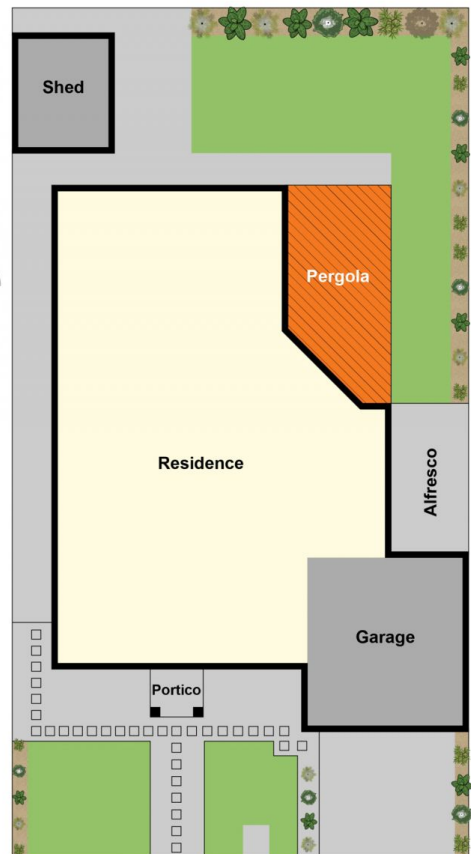
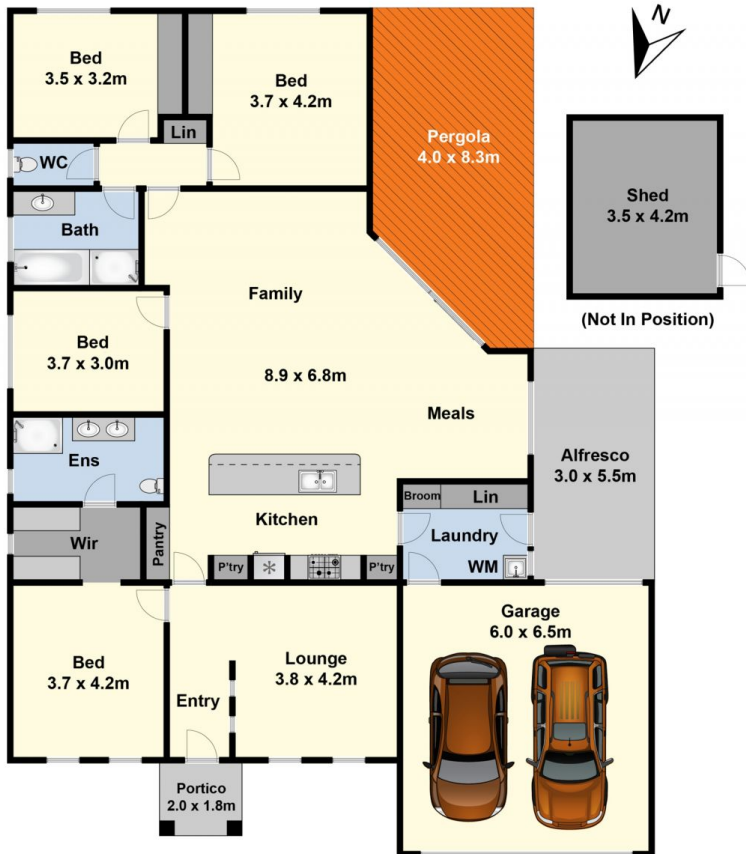

Site Plan