



40 Village Green Drive LEOPOLD VIC

4 2 2

This substantial size home has all the modern comforts and boasts three living areas, ideally suiting a growing family wanting extra space. Featuring a sizable main bedroom that acts as a parents retreat, complete with walk-in robe, ensuite with double vanity and shower, a further three bedrooms with built-in robes, tiles flow from the grand wide entrance through to the open plan living area, a functional kitchen including stone bench-tops, gas cooking, dishwasher and walk-in butlers pantry, meals area, formal lounge or theatre room, rumpus room for the kids, heating and cooling throughout, security system, a large double garage with internal access, an outdoor alfresco area and low maintenance garden. Close to the Gateway Plaza Leopold, parks and schools, there's nothing more to do than move in and enjoy.

[For full version visit the website](https://www.maxwellcollins.com.au)

Type : House

View : <https://www.maxwellcollins.com.au/sale/vic/geelong-district/leopold/residential/house/7456319>



Shaun Carroll
03 5222 4711

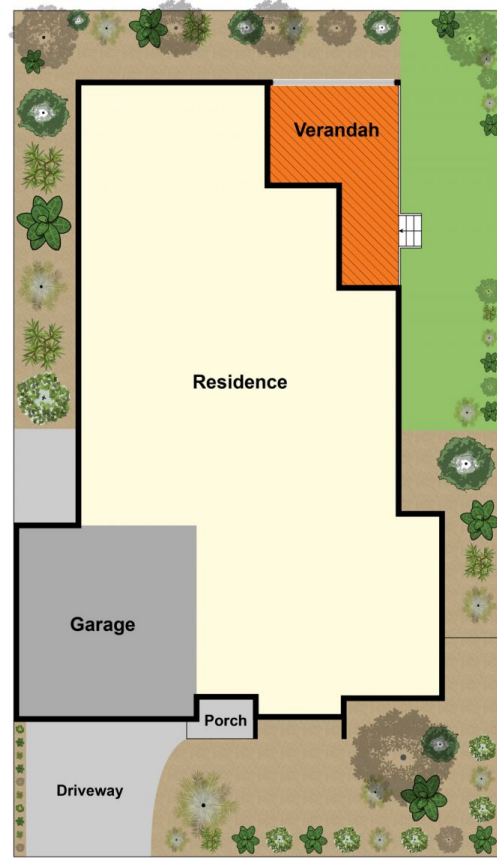

Site Plan