



## 9 Plumber Court GROVEDALE VIC

4 2 2

Ready made to simply move in and enjoy is this family home of practical living options positioned in a great location, close to shops, reserves, Grovedale primary school, Marshall train station and the beaches of the surf coast.

Consisting of four good sized bedrooms, master with WIR and ensuite, providing great accommodation, 2 living areas, family room overlooking the rear yard and separate lounge, a fully equipped kitchen & open meals and central heating throughout. Outside is a double garage with internal access and rear roller door ideal for extra storage of a trailer/boat, low maintenance garden and lawns, garden shed and a wonderful pergola which creates the perfect outdoor entertainment area for the family. This one is a real winner for the downsizer, young couple, family or

**Type** : House

**View** : <https://www.maxwellcollins.com.au/sale/vic/geelong-district/grovedale/residential/house/7456291>



**Duncan Skene**  
03 5222 4711

[For full version visit the website](https://www.maxwellcollins.com.au)

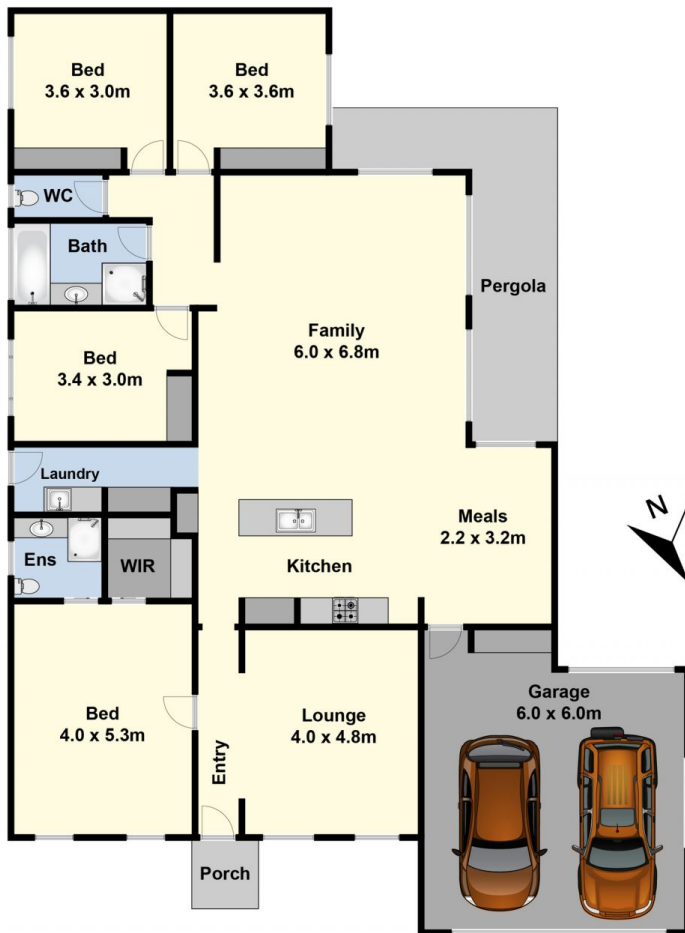

Ground Floor

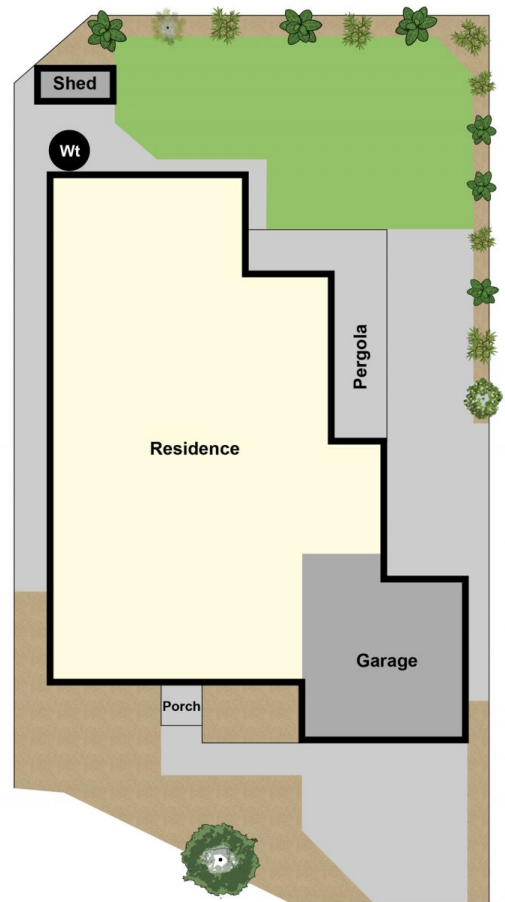

Site Plan