



## 1380 Rokewood-Shelford Road SHELFORD VIC

1 1

...the opportunity may arise to purchase this historic property.

Built in 1871, the former Leigh Shire Hall and Toll House (situated between Shelford and Rokewood) is ready for a new life as a residence, serviced accommodation, home occupation or art and craft gallery (subject to council approval).

Constructed of bluestone with timber lined rooms. Land 40.1 x 50.5m approx (2,043m<sup>2</sup>).

Terms: 10% deposit, balance 60 days.

**Type** : House

**Land Size** : 2043 sqm

**View** : <https://www.maxwellcollins.com.au/sale/vic/geelong-district/shelford/residential/house/7455729>

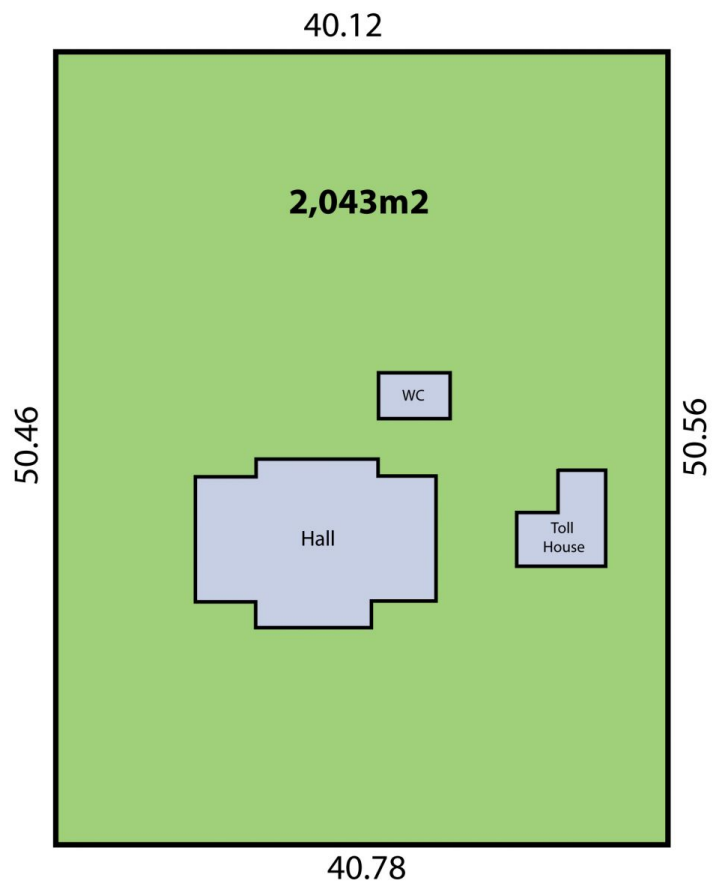

**1380 Rokewood-Shelford Road**