

7 Fyfe Place GEELONG VIC

2 1 1

Located only one house back from the iconic Eastern Beach and close to the city is this fabulous 2 bedroom double storey townhouse.

Imagine being able to walk to work and also enjoy the choice of wonderful restaurants and shops this area has to offer.

Features include gas heating and cooking in the open plan kitchen living area, huge laundry/utility room, good sized bedrooms with built in robes plus secure carport. This would make a great investment or enjoy living in a proven capital growth area.

Type : Townhouse

View : <https://www.maxwellcollins.com.au/sale/vic/geelong-district/geelong/residential/townhouse/7455681>



Eugene Carroll
03 5222 4711

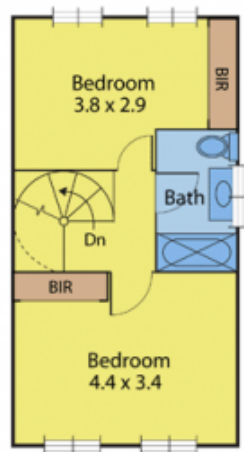

First

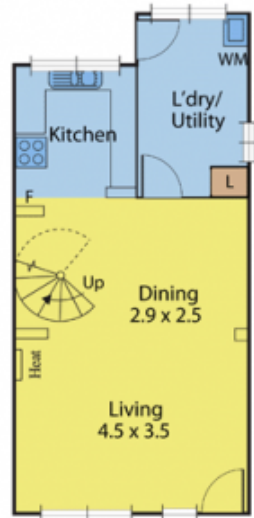

Ground

