



1 Titian Court GROVEDALE VIC

4 2 1

This amazing property is located in a quiet court location and is ideal for any family. 4 bedrooms all with BIRs, master with WIR and ensuite, 2 separate living areas and 2 separate dining areas ensure an abundance of room to move. Includes all modern comforts such as DW, evap cooling, gas heating and cooking, internal entry from the remote entry garage and ample off street parking for additional cars or the caravan. There's an OFP for cooler nights and a large decked pergola area with views of Geelong for outdoor entertaining. This property is sure to impress!

Type : House

View : <https://www.maxwellcollins.com.au/sale/vic/geelong-district/grovedale/residential/house/7455405>

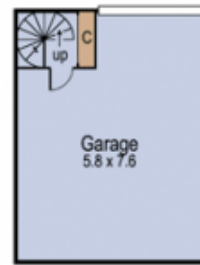

Lower Level

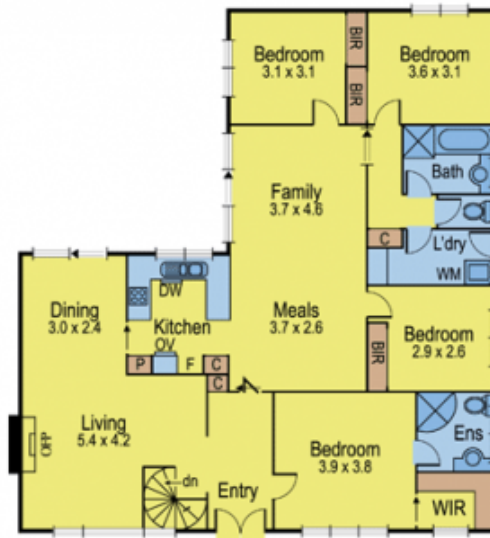

Upper Level