



## 2779 Midland Highway LETHBRIDGE VIC

1 1

Once in your life the opportunity arises to purchase this historic property. Built in 1914, the former Lethbridge Catholic Church is now ready for a new life as a residence, B & B, home occupation, art and craft gallery (subject to council approval). Extensive timber work throughout is a standout feature. Prominently located on a corner block to enhance its future use. Building area 125m<sup>2</sup>. Land 40m x 50m (2000m<sup>2</sup>). Zoning Township. Terms: 10% deposit, balance 60 days.

**Type** : House

**View** : <https://www.maxwellcollins.com.au/sale/vic/geelong-district/lethbridge/residential/house/7455389>

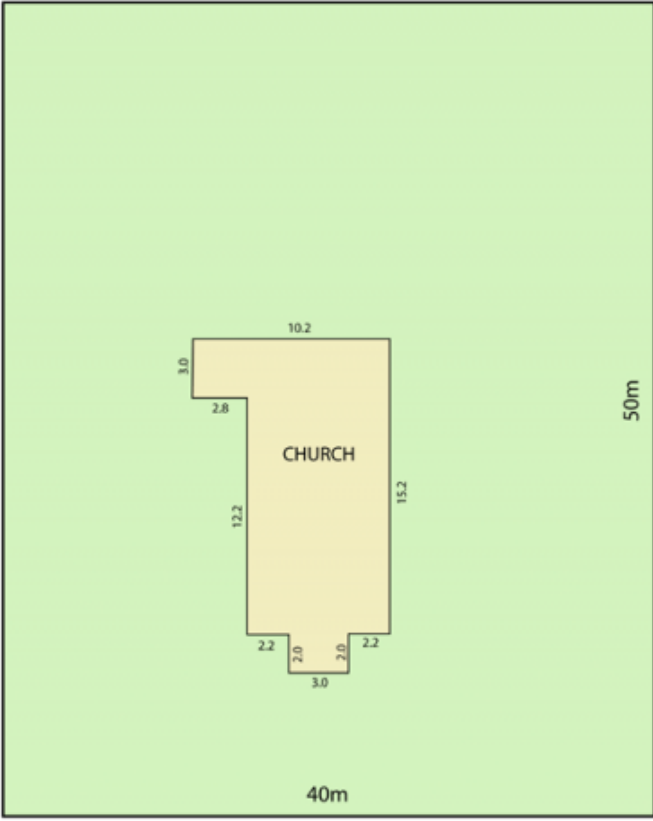

MIDLAND HIGHWAY

NOT TO SCALE