

1 Aberdeen Street NEWTOWN VIC

6 2 1

Circa 1890, this outstanding property presents a unique opportunity for a buyer seeking a high profile location or an astute investor with an eye to the future. Eminently livable at present (most recently used for student accommodation), this property boasts 5/6 bedrooms, 2/3 separate living areas, 2 bathrooms, powder room, central kitchen and adequate parking options. Zoned residential 2, the residence would benefit from some refurbishment and offers exceptional flexibility along with its central location close to the CBD, waterfront, train station and prestigious schools to name a few. This is a chance of a lifetime, don't be the one to miss out.

Type : House

View : <https://www.maxwellcollins.com.au/sale/vic/geelong-district/newtown/residential/house/7455295>

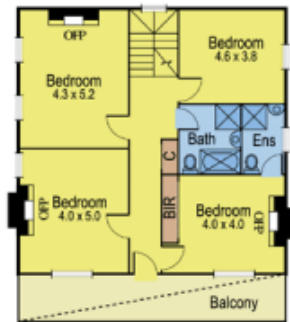

First Floor



Ground Floor

