



5/22 Essington Street Grovedale VIC

- * Approx. 180m², floor area and mezzanine 48m²
- * Well fitted out office, kitchen, amenities and mezzanine
- * Vacant possession
- * Shared carparking
- * Industrial 1 zone

Type : Industrial
Building Size : 228 sqm
View : <https://www.maxwellcollins.com.au/sale/vic/geelong-district/grovedale/commercial/industrial/7454385>



Paul Whyte
03 5222 4711

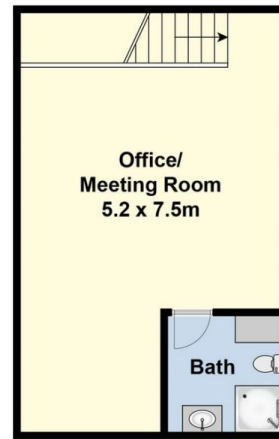

First Floor



Ground Floor